

# HP Latex 110, 300 and 500 Printer Series

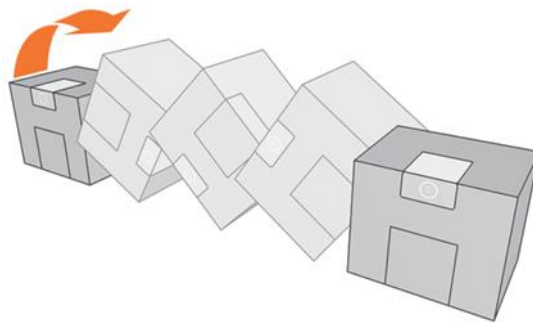

## Prepare the printer for printing again after an extended downtime

1. If the ink lines were flushed, contact your support representative to recover the printer.
2. If needed, move the printer to its final location.
3. Reconnect the printer, turn on the rear switch, and press the front panel button.
4. If the printer has a 3-liter kit, remove each cartridge, place it on a flat surface, and turn it 360 degrees four times.



5. Remove the ink cartridges using the ink menu option on the front panel “replace intermediate tanks” or “ink cartridges”, depending on the printer, and shake them for 15 seconds before reinstalling. If the printer has a 3-liter kit, do the same with the intermediate tanks.

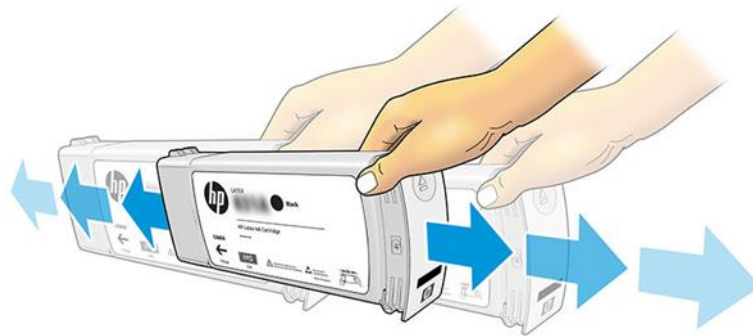

The following steps 6 to 12 need to be followed sequentially in order to maximize the chances of printhead recovery.

6. Only if the printheads have been removed, shake them for 15 seconds before reinstalling.

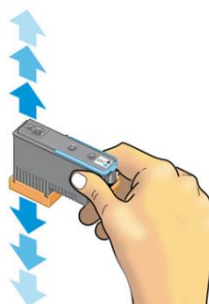

7. Only if the printheads have been removed, before inserting the printheads into the printer, for all colors except the optimizer, follow the “Manual printhead cleaning procedure”, which can be found [here](#).



---

**IMPORTANT:** Make sure not to pour any water on the electrical contacts or any other part of the printhead apart from the nozzles, since it could damage the printhead irreversibly.

---

8. Only if the printheads have been removed, insert the printheads by following the replacement procedures.
9. Run a clean printheads routine on all printheads.
10. Print a printhead status plot to verify printhead health. If the printhead health requires improvement continue with steps 11 and 12.
11. Run a clean printheads routine on all printheads.
12. Once the clean printheads routine has been completed, evaluate printhead health as recommended in step 10. If the printhead health is recovered move to step 13. Otherwise, repeat steps 11 and 12 with up to 3 clean printhead routines.
13. If you are experiencing ink mixing issues, print a dump plot to recover the printhead.
14. Run a printhead alignment.
15. If color accuracy is required, run a color calibration.
16. Do not print critical image-quality jobs for the first 2 meters.

For any additional help or clarification, please contact your support representative.