



Firmware PLS_33_22_39.1 is available

For the HP Latex 700 / 800 printer series

November 2022

A new firmware version PLS_33_22_39.1 is now available to download and install for the HP Latex 700 and 800 printer series. HP strongly recommends installing this new firmware version on all units, as it includes significant improvements. Please note this replaces the previous version PLS_32_22_23.7.

Firmware can be upgraded by downloading the firmware package from the hp.com website.

Related links:

www.hp.com/go/latex/

Printers related to this article

HP Latex 700 and 800 printer series

How to install the firmware

Download the firmware file from the product support page:

- <https://support.hp.com/us-en/drivers>

On the download website you can find three different files to download. This is because the FW file is compressed and divided into three parts (001, 002, and 003). It is necessary to download all three parts.

NOTE: Since Windows Zip does not support split files, it will be necessary to use a third-party zip software.

A limitation has been detected using Internet Explorer when downloading the partition files of the zip.

The recommendation is to use Chrome to access the website, then download each file.

Click with the central mouse button and the download will start automatically in the download bar. Alternatively, right click on the file and select **Open in a new tab**, like in the image below.

PLS_26_21_27.1.rfu.7z.002	1000.0 MB	Down	<ul style="list-style-type: none"> Open link in new tab Open link in new window Open link in incognito window Save link as... Copy link address AdBlock — best ad blocker Inspect
PLS_26_21_27.1.rfu.7z.003	889.0 MB	Down	
▶ HP Latex 700/700 W and HP Latex 800/800 W Printers Firmware	PLS_26_22_01.1	Feb 28, 2022	
Multi-part download			
PLS_26_22_01.1.rfu.zip.001	975.0 MB	Down	
PLS_26_22_01.1.rfu.zip.002	975.0 MB	Down	
PLS_26_22_01.1.rfu.zip.003	938.8 MB	Down	

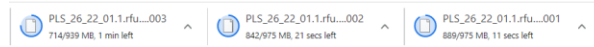

Once all zip files are downloaded, right click the file **PLS_26_22_01.1.rfu.zip.001** and unzip it with the third-party zip software (do not use Microsoft Windows Zip). This will produce the file **PLS_26_22_01.1.rfu.fmw**.

Upgrade instructions

IMPORTANT: The jobs on the front panel print queue will be deleted when updating the firmware. You will need to send them again from the RIP software to have them available on the front panel job queue.

There are two options to update the firmware to the latest version.

Firmware update using a USB flash drive

1. Download the firmware package and store it on the USB flash.
(MD5: 2ad82b4b14453b619fd50913ee6e4ea8)

IMPORTANT: The USB flash drive should contain only one firmware file (.fmw) in the drive's root folder, and no other files.

2. Connect the USB flash drive to the USB connector at rear of the printer.
3. Follow the onscreen instructions on the front panel.

Specifications of the USB flash drive:

- USB 2.0 compatible
- At least 8 GB capacity
- FAT 32 preformatted
- No hardware encryption

Firmware update using the Embedded Web Server

1. Download the firmware package and store it on the RIP PC's hard disk.
2. Access the Embedded Web Server by entering the IP address of the printer on a web browser.

NOTE: You might be required to enter user and password details. Type **admin** in each field and tap **Login**.

Sign in
https://15.83.6.159

Username

Password

NOTE: This password can be configured on the front panel of the printer. Refer to the Service Manual for more information.

3. In the Embedded Web Server, select **Information** and then **Firmware update > Manual firmware update**.

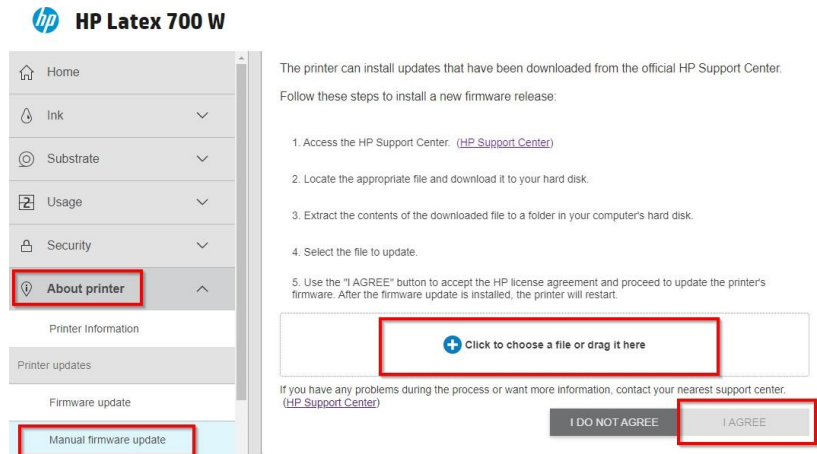

4. Browse to select the downloaded .fmw file and click **Agree**.
5. The printer will reboot itself when the FW upgrade is completed.

Details of fixes and enhancements

New functions

HP PrintOs Print Beat live production

Live Production (powered by PrintOs/PrintBeat) is only available for printers with an active HP Professional Print Service Plan Plus. The application will be released for the HP Latex 700/800 product series on December 1, 2022, and this firmware will support it. Contact your HP sales representatives for more information about how to purchase it.

IMPORTANT: The printer must be connected to the internet. For printers under warranty, this function will be disabled if no Service Plan Plus is activated in the three months following the registration of the printer in PrintOS.

Easily identifiable jobs and job queues of all registered printers across multiple sites are available in one comprehensive, at-a-glance view. With live production managers, operator status reports

are no longer necessary. You can minimize production gaps, streamline cross communications, and confidently print unattended because all information is received in real time.

Aggregated view of printer's queues

Easily identify jobs: Job thumbnails

Accurate job queued estimations

Easily switch from past and upcoming jobs

The screenshot displays the HP PrintOS interface with a 'Print Beat' section titled 'Live production'. It features a timeline from 9:30 to 15:30. Jobs are represented as cards with thumbnails and status indicators (e.g., 'Ready', 'Completed', 'Failed'). A search bar is visible in the top right. Below the screenshot, four callout boxes highlight specific features:

- Ease access via [PrintOS](#)* (pointing to the PrintOS logo)
- Print Beat interoperability for job history details & reports* (pointing to a job card)
- Glanceability* (pointing to a job card)
- Easily identify jobs: Job status searcher* (pointing to the search bar)

HP Live Production allows the end user to:

- Identify job status with aggregated and visual representation of all your HP printers' queues in a single view.
- Streamline cross-team communications to reduce dependencies and improve coordination across departments.
- Minimize production gaps by preventing upcoming events thanks to accurate job queue estimations.

Known limitations for HP Latex 700/800 product series

NOTE: the following limitations will be fixed in future versions of the software. It does not require firmware update.

- Queued jobs (up next) from front panel reprints do not have the correct job duration estimation. The print time is indicated as 15 minutes by default and the print mode information is missing. This will be fixed in the next firmware release.

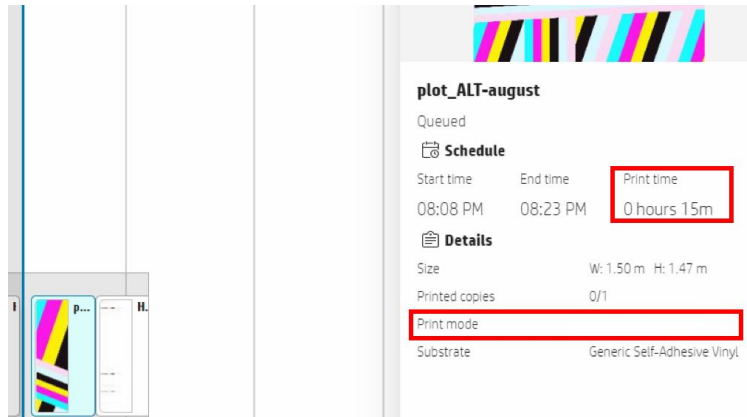

- When the media is loaded and the media configured on printer have a size mismatch, the jobs remain on hold in the front panel and do not appear in live production:

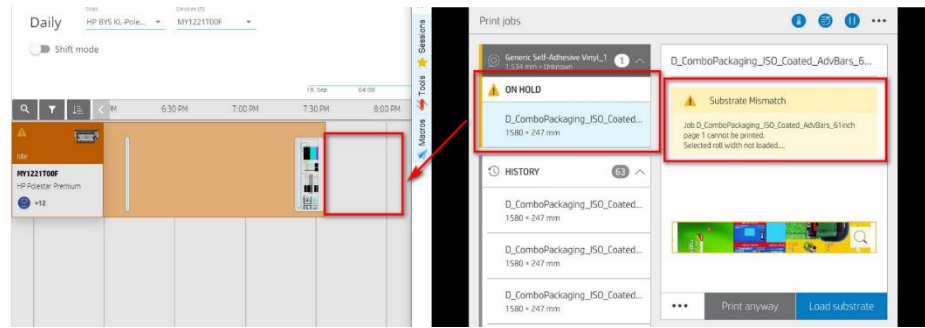

When the media size is set to the correct one, the jobs appear in live production in queue and printing:

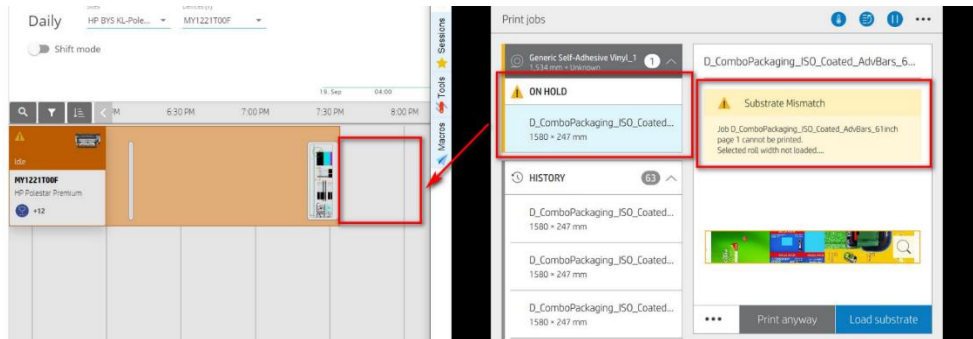

- When there is an error, and the printer stops to print (any system error, any of the printer windows/doors are open, etc.). The job status changes to 'on hold' again and do not appear.

When the issue is resolved, the user must manually move jobs from on hold (release) to printing queue, and the jobs will appear in live production again.

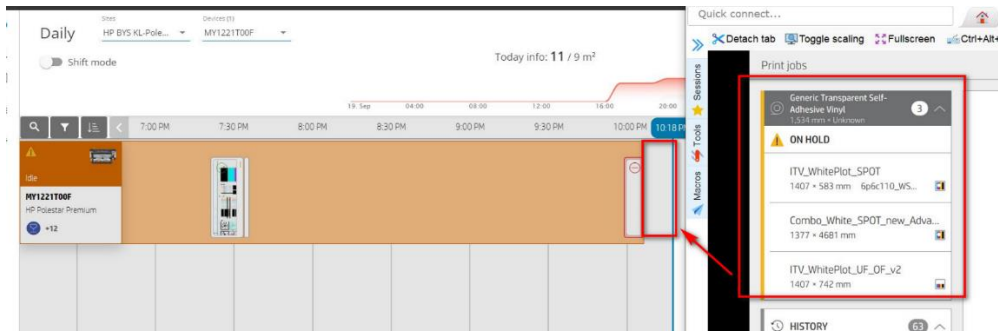

- When there is a different type of media configured for the jobs than that configured in the printer, the jobs stay paused. This state is similar to on hold status and does not appear in production.

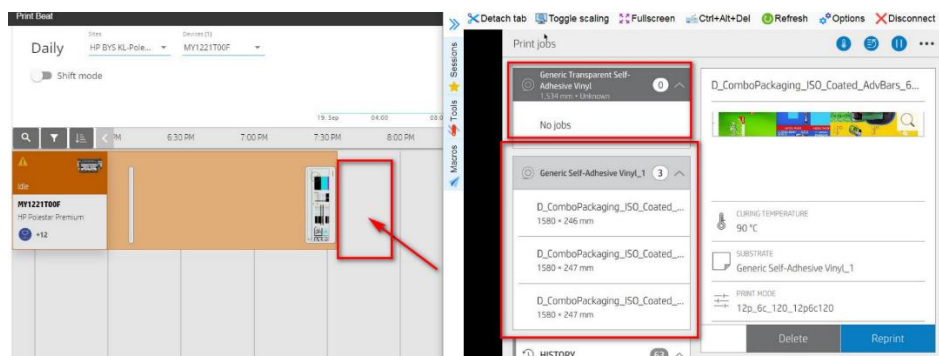

Additionally, the user can manually pause the jobs.

When the correct media is set, the jobs appear in live production in the queue and printing.

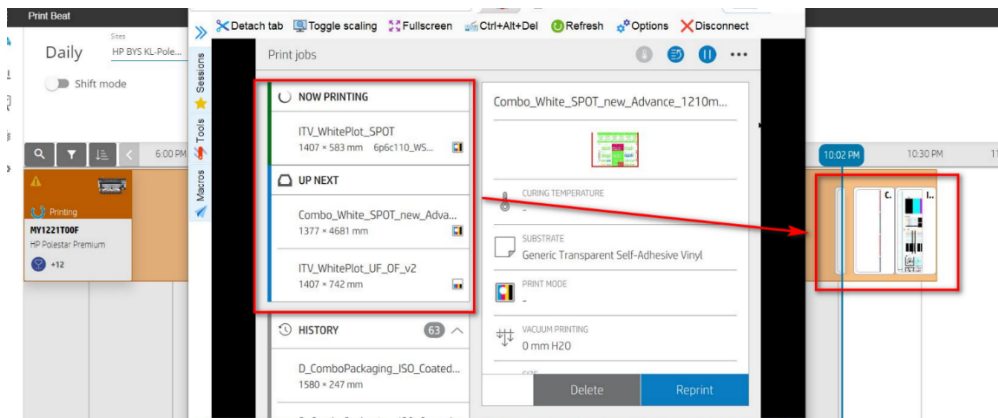

Bug fixing in system diagnostics

Fixed a firmware bug affecting several service diagnostics.