

# Firmware PLS\_40\_22\_52.1 is available



For the HP Latex 700 / 800 printer series

February 2023

A new firmware version PLS\_40\_22\_52.1 is now available to download and install for the HP Latex 700 and 800 printer series. HP strongly recommends installing this new firmware version on all units, as it includes significant improvements.

Firmware can be upgraded by downloading the firmware package from the [hp.com](http://hp.com) website.

Related links:

[www.hp.com/go/latex/](http://www.hp.com/go/latex/)

Printers related to this article

[HP Latex 700 and 800 printer series](#)

## How to install the firmware

Download the firmware file from the product support page:

- <https://support.hp.com/us-en/drivers>

On the download website you can find three different files to download. This is because the FW file is compressed and divided into four parts (001, 002, 003 and 004). It is necessary to download all four parts.

---

**NOTE:** Since Windows Zip does not support split files, it will be necessary to use a third-party zip software.

---

**IMPORTANT:** The jobs on the front panel print queue will be deleted when updating the firmware. You will need to send them again from the RIP software to have them available on the front panel job queue.

---

## Details of fixes and enhancements

The main changes and improvements of this release are as follows:

- Workflow productivity improvements.
- Media path improvements.
- Diagnostic improvements.
- Ink setup improvements (purge process at printer installation).
- Bugs fixed and general improvements.

### Workflow productivity improvements

#### Self-maintenance routine (white ink recirculation process)

With this new firmware release the white ink delivery recirculation process can be cancelled. This improves the response time considerably in case any urgent action needs to be performed in the middle of the self-maintenance routine.

The recirculation itself will also be automatically cancelled if the end-user triggers any action that blocks the self-maintenance process (new message and workflow).

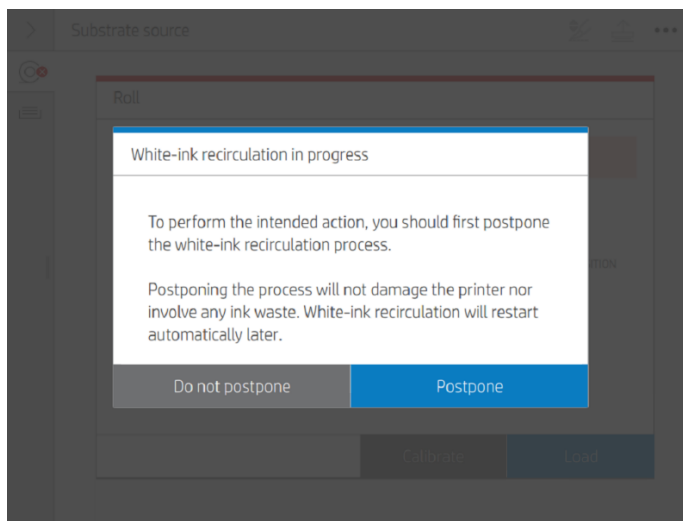

This message will be shown with any action that requires the cancellation of this routine such as media loading and unloading, cutting, etc.

The cancel process could take up to 6 minutes but on average approximately 2 minutes, similar to the rest of the calibrations (CLC, ICC, check and clean, PH alignment, nozzle health, etc.) that will now take approximately 2 minutes to be cancelled.

## Workflow productivity improvements

### Self-maintenance routine (white ink recirculation process)

With this new firmware release the white ink delivery recirculation process can be cancelled. This improves the response time considerably in case any urgent action needs to be performed in the middle of the self-maintenance routine.

The recirculation itself will also be automatically cancelled if the end-user triggers any action that blocks the self-maintenance process (new message and workflow).

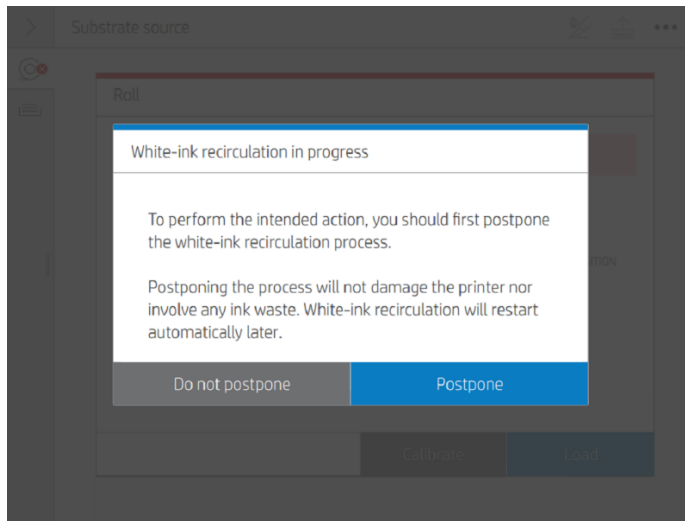

This message will be shown with any action that requires the cancellation of this routine such as media loading and unloading, cutting, etc.

The cancel process could take up to 6 minutes but on average approximately 2 minutes, similar to the rest of the calibrations (CLC, ICC, check and clean, PH alignment, nozzle health, etc.) that will now take approximately 2 minutes to be cancelled.

### User-recovery / Automatic-recovery

A new recommendation message will pop up to advise for a checking and cleaning calibration, if the printer has not been used for over 3 days. It will be shown after turning the printer on and when it wakes up.

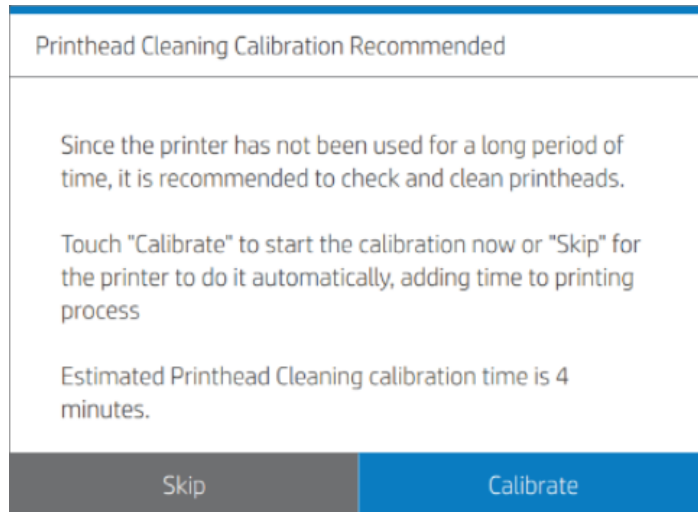

Additionally, it is possible to now cancel user PH recovery in less time. The user may also cancel automatic recovery and drop detection.

### **Remove Drop Detection**

The new firmware now does not perform an automatic drop detection after unexpected shutdown (due to a system error, power cut or a similar event), in next plot.

### **Avoid cooldown process in white PH removal if last job is from 1 hour**

The current firmware understands that it is not necessary to perform the cooldown process during white-ink printhead replacement when not printing for 1 hour or printhead temperature is below 5 °C vs ambient.

## HP control print is included as an internal diagnostic plot

The option to print the IQ quality plot directly from the printer's IQ menu has been added.

Optimize printing quality -> <sup>ooo</sup> -> HP Control Print diagnostic plot.

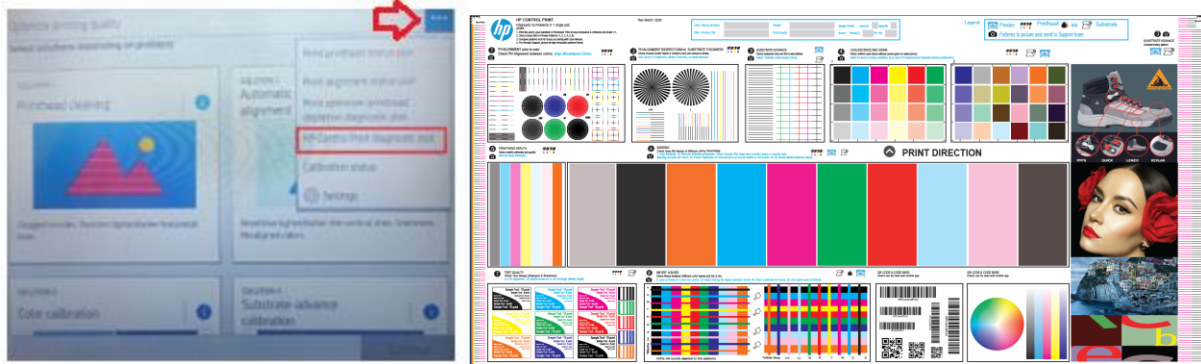

---

**NOTE:** In the following link you can download the guide to understand the HP Control Print diagnostic plot results.

<https://myknowledge.hpcloud.hp.com/documents/1749ec6e-e894-4218-9d5a-098ed29df184>

---

## Media path improvements

### Media load improvements

This new firmware release includes improvements during the media loading process.

New FW measure skew after manual skew correction alignment, if the skew is still over skew value set, the pop-up to correct manually will appear again. This step can be repeated up to 3 times. If the skew is below the skew value set, the printer will continue finishing the loading process.

---

**NOTE:** This performance is added also to last servicing routines during wake up backwards movement to avoid unloading issues during automatic maintenance.

---

Furthermore, the new firmware includes a new media saver setting. By enabling it while the substrate is being loaded, the curtain opens to allow the leading edge and media saver to pass.

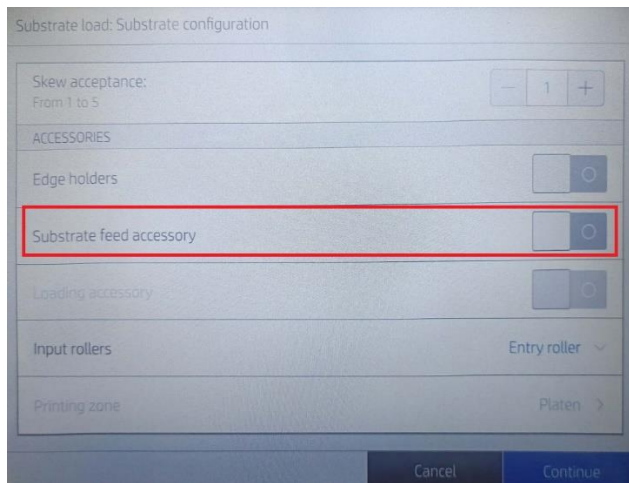

### TUR, TLR Improvements

- Issues avoided when the TUR stops collecting media.
- Skew algorithm improvement.
- Changes to avoid TUR trapping the media while printing.