

New firmware release VEGA_00_25_19.1



For the HP Latex 730 and 830 Printer Series.

Related links:
www.hp.com/go/latex/

June 2025

Upgrade instructions

There are two methods to update the firmware to the latest version.

Option 1: Firmware update using a USB flash drive

1. Download the firmware package from:
<https://support.hp.com/us-en/drivers/hp-latex-830-w-printer/2102537188>.

Then, store it on the USB flash drive.

MD5 checksum: ef82b8960ca3d1dac295a34a4813272

 **IMPORTANT:** The USB flash drive should contain only one firmware file (.fmw) in the USB drive's root directory. No other files should be present.

2. Insert the USB flash drive into the rear USB port on the printer.
3. Follow the instructions displayed on the front panel.

The USB flash drive must have the following specifications:

- USB 2.0 compatible
- Minimum capacity: 8 GB
- Preformatted to FAT32
- No hardware encryption

Firmware update using the Embedded Web Server

1. Download the firmware package and store it on the hard disk of the RIP PC.
2. Access the Embedded Web Server by entering the printer's IP address into a web browser.

 **NOTE:** You may be prompted to enter user credentials. Enter "admin" for both the username and password, then click **Login**.

Sign in

https://15.83.6.159

Username

Password

 **NOTE:** This password can be configured on the printer's front panel. Refer to the Service Manual for more information.

3. In the Embedded Web Server, select **Information** → **Firmware update** → **Manual firmware update**.

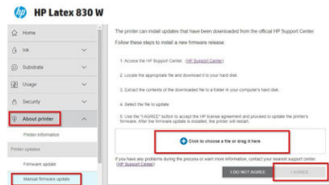

4. Locate the downloaded .fmw file and select **Agree**.
5. The printer will reboot when the firmware upgrade is complete.

Firmware update using Automatic Firmware Update

1. On the front panel go to **Info**.

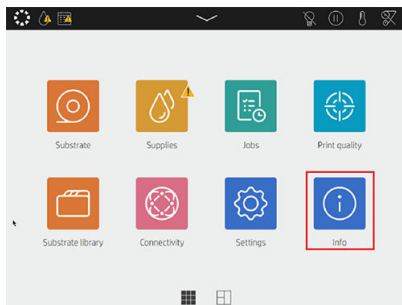

2. Press the arrow on the top-left corner and select **Firmware**.

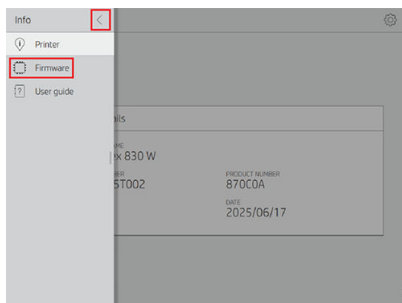

3. Press **(1) Check** for the latest available firmware. HP also recommends activating the Automatic Firmware Check by clicking **(2) the gear**:

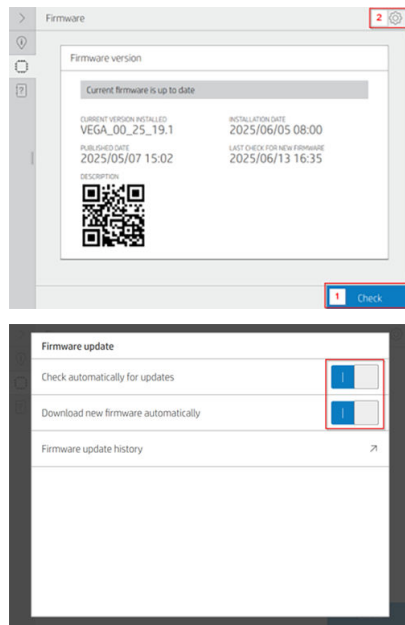

Main updates and improvements

This firmware release focuses on resolving issues. See the full list of updates and improvements below:

- Media control improvements.
- Fixed the overlapping text found in several windows.
- System Error 8112-B090-0000 is fixed after sending a plot with a PVC-free banner.
- System Error 87B8-1A7E-0000 displayed on the front panel after the printer is left idle overnight.
- Media properties have changed:
 - Default curing temperature has changed from 85 to 90° for 6p6c100 in synthetics and PET front lit.
 - Optimizer level setup at 12 for color and 22 for white in SAV for OF100.